

- Site**
- Planning Application Boundary
- Proposed Building
- Proposed Canopy/Building Overhang
- Proposed Main Entrance
- Proposed Classroom Entrance
- Proposed Plant Room Entrance
- Existing Tree
- Existing Hedge
- Existing Vegetation Removed by Facilitate Development
- Existing Floodlighting Columns for Neighbouring Leisure Centre At Weather Pitch (AWP)
- Existing Retaining Wall
- Existing surface water easement and manhole locations TBC, position taken from Topo Survey
- Planting**
- Refer to Planting Strategy Ref: YPB-ALA-00-XX-DR-L-00015
- Proposed Tree
- Amenity Lawn
- Amenity Planting
- Sensory Planting
- Hedge Planting
- Meadow Planting
- Swale Meadow Planting
- Woodland Planting
- Green Screen 'Fedge'
- Paving**
- [Ref. P01] Pedestrian Macadam
- [Ref. P02] Vehicular Macadam
- [Ref. P03] Permeable Macadam
- [Ref. P04] EPDM Wetpore Safety Surface
- [Ref. P05] Reinforced Turf
- [Ref. P06] MUGA Permeable Surface
- [Ref. P07] Play Markings
- [Ref. P08] Concrete Pad
- [Ref. P09] Self binding gravel
- [Ref. P10] Cobbled sensory path
- [Ref. P11] Concrete Block Paving to Plaza
- [Ref. P12] Concrete Block Paving to vehicular areas
- [Ref. P13] Concrete Block Paving to parking areas
- [Ref. P14] Concrete Block Paving to transfer strips
- [Ref. P15] Concrete Block Paving Circle
- [Ref. P16] Hazard Paving - Tactile
- [Ref. P17] Hazard Paving - Corduroy
- [Ref. P18] Sport Markings to MUGA
- Furniture**
- [Ref. S1] Cycle Shelter
- [Ref. S2] Bike/Scooter Storage
- [Ref. S3a) External Shed
- [Ref. S4] Wooden Shelter
- [Ref. S5] Shade sail
- [Ref. S6] Play Equipment + associated safety surface
- [Ref. S7] Raised Planter
- [Ref. S8] Picnic bench
- [Ref. S9] Bench Seating
- [Ref. S10] Wayfinding Signage
- [Ref. S11] Electric Car Charging Point
- [Ref. S12] Bollards
- [Ref. S13] Door Protection Barrier
- [Ref. S14] Parking Entrance Built Out
- [Ref. S15] Parking Islands
- [Ref. S16-19] Habitat houses
- Fencing and Structures**
- Proposed Fencing
- Proposed Gates

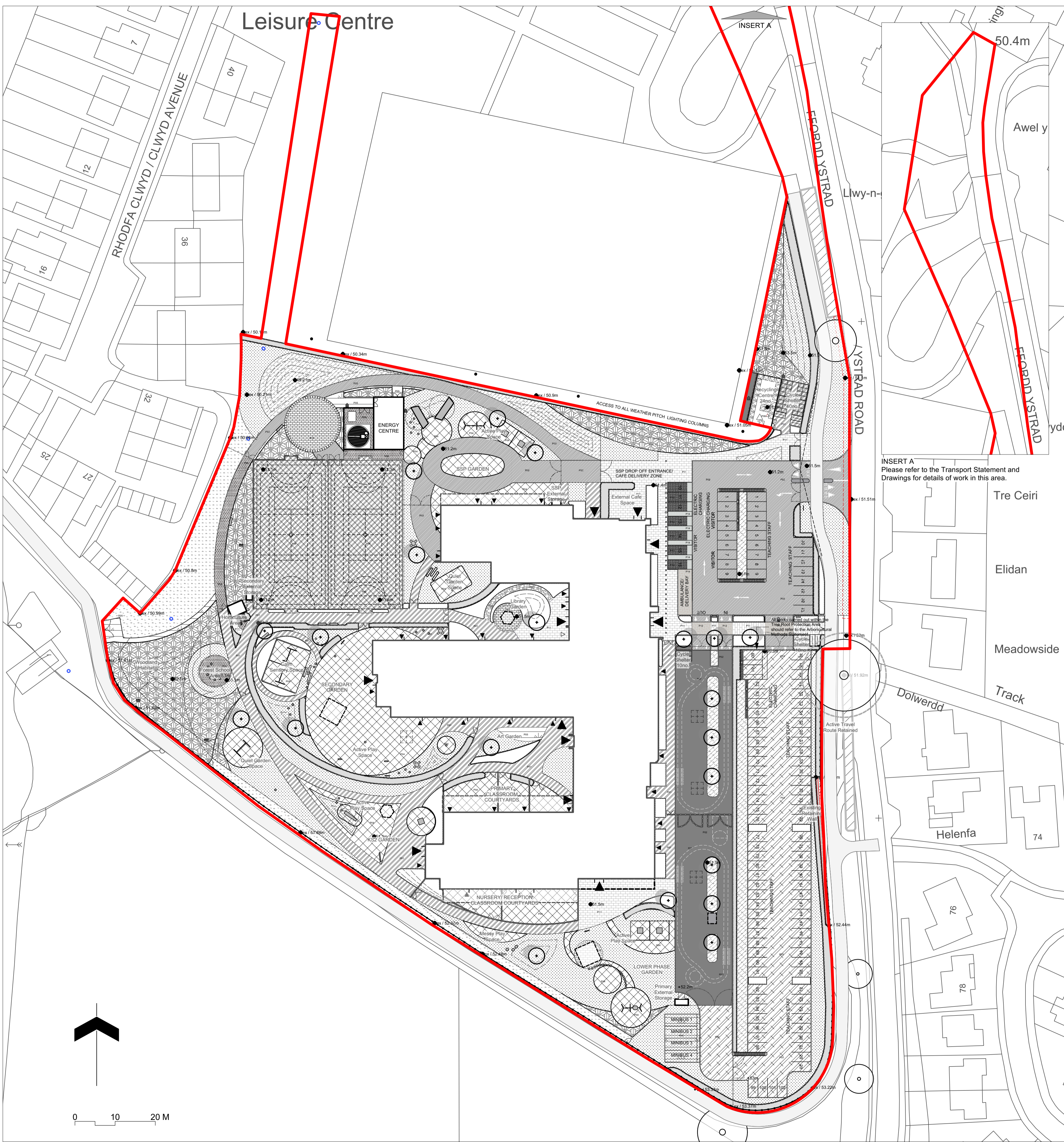

NOTES

- Do not scale from this drawing.
- All dimensions are in meters unless otherwise noted.
- Information shown outside extent of works is for illustrative purposes only.
- To be read in conjunction with all other Landscape Architect's drawings.
- Drawings YPB-ALA-XX-XX-DR-L-00000 Series, Details YPB-ALA-XX-XX-DR-L-10000 Series, NBS - YPB-ALA-XX-XX-SP-L-00002 MPP - YPB-ALA-XX-XX-RP-L-00001
- To be read in conjunction with all other disciplines' drawings and specifications.
- Specification and details of build ups to paving, kerbs, edges and structures to be advised by Project Civil Engineer.
- All subbases to retaining features, walls to Project Engineers details.
- Formations levels are to be inspected and approved by the Project Engineer.
- Highway works by others, cross over and carpark please refer to Civils package.
- Drainage design, manhole cover positions & final levels to be coordinated with Drainage Engineers.
- Lighting design, to be coordinated with M&E details, columns are shown for coordination only.
- Landscape contractor is responsible for all area take offs. Any areas or quantities shown are for information only. Plant numbers should account for slopes/gradients.
- Plant substitutions require approval from Landscape Architect / Client due to safeguarding and health and safety issues in relation to SEND client requirements.
- Any work to existing trees to be carried out by a suitably qualified Tree Surgeon; All work to be carried out in accordance with AMS. Tree Consultant to advise on all issues regarding works in relation to trees.
- The following elements are intended to be specialist design packages, subcontractor / specialist to submit drawings for approval prior to procurement and manufacture: a. street furniture b. canopies c. cycle stores d. metalwork package fencing, e. gates etc. Access control to be coordinated by M&E Consultant tbc by School. Sports furniture and finishes.
- The following elements are intended to be specialist design packages, subcontractor / specialist designer to submit drawings for approval prior to procurement and manufacture: a. all street furniture b. external classroom canopies c. cycle store d. metalwork package including all fencing, handrails, gates etc. Access control / Gate suiting to be coordinated with WCL/ M&E Consultant tbc by School & DCC, sports furniture / finishes / linemarkings. All specialists to submit drawings for approval prior to procurement and manufacture and ensure these are designed in accordance with all relevant BS Standards and Guidance.
- The contractor is to check all setting out information, levels and dimensions before construction. Any discrepancies are to be brought to the attention of Ares Landscape Architects before commencing on site.
- Refer to design risk assessment for details in relation to safeguarding / security issues due to SEND client requirements.
- Site clearing works as per Ecological and Arboricultural reports.
- Topsoil / Subsoil stripping to be carried out in accordance with Arboricultural Input for site strip, storage, remediation and repositioning on site. To be carried out in accordance with the Wales Soft Work Manual.
- Provide small gaps of at least 15cm x 15cm at designated points under all boundary fences to allow movement of small mammals/hedgehogs. These are inductively shown on the sustainability and biodiversity plans YPB-ALA-00-XX-DR-L-00029 in 11No. locations.
- Incoming services, meter, substations to MEP Information. Please refer to their package for detailed layouts.
- Drainage design by Drainage Engineer, please refer to Curtins information.

ID	RISK	MITIGATION	DATE MITIGATED
<b>RESIDUAL PROJECT RISKS</b>			

DATE	REV	DESCRIPTION OF REVISION	DRAWN BY	APPROVED BY
07/09/2022	P10	Updated Red Line for Planning Issue	KP	KP
30/08/2022	P09	Issued for Planning	KP	KP

**REVISIONS**

**STATUS**  
**S2 - FOR PLANNING**

**ares**  
LANDSCAPE ARCHITECTS

Ares Landscape Architects LTD  
Gatecrasher,  
51 Eyre Lane  
Shrofford  
S1 4RB  
t: 0114 276 2000  
e: hello@aresdesign.co.uk  
w: ares.eu.com

CLIENT:  
**Wates Construction Ltd**

PROJECT TITLE:  
**Ysgol Plas Brondyffryn SEN**

DRAWING TITLE:  
**Landscape General Arrangement**

DRAWING SCALE: 1:500  
PAPER SIZE: A1

DRAWN BY: KP  
APPROVED BY: KS

DRAWN DATE: 26/01/2022  
ALA PROJECT CODE: ALAT25

DRAWING NUMBER: **YPB-ALA-00-XX-DR-L-00004 S2**  
STATUS: **P09**