

END MILL HOLDERS



FEATURES

- For clamping shank diameters 6-50mm
- Gauge lengths up to 200mm
- Balanced to minimum 15,000RPM G6.3 on most tapers
- Side locking screw for weldon shank tools

BENEFITS

- Excellent rigidity
- Excellent protection against tool pull out
- Low cost

Cutwel End Mill Holders / Side Lock Arbors for Weldon Shank Tools

The Cutwel range of end mill holders covers all major taper types and sizes, with gauge lengths available up to 200mm.

Our side lock arbors are balanced to 15,000RPM grade G6.3 as standard.

Sidelock arbors offer excellent protection against tool pull out and offer increased rigidity compared to ER collet chucks in roughing operations.



CONTENTS

BT MAS BT30, BT40, BT50.....P1024	HSK-F HSK50-F, HSK63-FP1027	DIN2080 ISO30, ISO40, ISO50P1030
DIN 69871 SK40, SK50.....P1025	PSC Capto Compatible PSC40, PSC50, PSC63, PSC80, PSC100.....P1028	QUICK CHANGE QC30, QC40.....P1030
HSK-A HSK40-A, HSK50-A, HSK63-A, HSK100-A.....P1026	DOUBLE CONTACT DBT DBT30, DBT40, DBT50.....P1029	R8 Bridgeport Taper.....P1031
HSK-E HSK50-E, HSK63-E.....P1027	DOUBLE CONTACT DSK DSK40, DSK50P1029	EXTENSION/REDUCTION SLEEVES Weldon.....P1031

LENGTHS

Lengths	BT30	BT40/50	SK40/50	HSK-A 40/50	HSK-A 63/100	HSK-E	HSK-F	PSC	DBT DSK	DIN2080 ISO30/40/50	QC 30/40	R8
Extra Short	✓	✓	✓	-	-	-	-	✓	✓	✓	✓	✓
Standard (60-80mm)	✓	✓	✓	✓	✓	✓	✓	✓	✓	✓	✓	✓
Long (100-120mm)	-	✓	✓	-	✓	-	-	-	-	-	-	-
Extended (160mm)	-	✓	✓	-	✓	-	-	-	-	-	-	-
Extra Long (200mm)	-	✓	✓	-	-	-	-	-	-	-	-	-





END MILL HOLDERS BT MAS

Side Lock Arbors for Weldon & Flat Shank Tools

- ▶ Balanced to G6.3 15,000RPM
- ▶ <200mm gauge length



P990



BALANCED 15,000RPM • G6.3

Taper	Dia.	Nose Dia.	Gauge Length	ORDER CODE	PRICE	Taper	Dia.	Nose Dia.	Gauge Length	ORDER CODE	PRICE		
BT30	6	25	50	BT30-EMH6-50	▲	BT50	6	25	63	BT50AD/B-EMH6-63	▲		
	8	28	50	BT30-EMH8-50	▲				100	BT50H100-WE06	▲		
	10	35	50	BT30-EMH10-50	▲				160	BT50H160-WE06	▲		
	12	42	55	BT30-EMH12-55	▲				200	BT50H200-WE06	▼		
	16	48	63	BT30-EMH16-63	▲		8	28	63	BT50AD/B-EMH8-63	▲		
	20	52	63	BT30-EMH20-63	▲				100	BT50H100-WE08	▲		
BT40	6	25	100	BT40AD/B-EMH6-50	▲				160	BT50H160-WE08	▲		
			160	BT40H160-WE06	▲				200	BT50H200-WE08	▼		
			200	BT40H200-WE06	▲		10	35	65	BT50AD/B-EMH10-65	▲		
			50	BT40AD/B-EMH8-50	▲				100	BT50H100-WE10	▲		
	100	BT40H100-WE08	▲	160	BT50H160-WE10				▲				
	160	BT40H160-WE08	▲	200	BT50H200-WE10				▼				
	8	28	28	200	BT40H200-WE08		▲	12	42	80	BT50AD/B-EMH12-80	▲	
				63	BT40AD/B-EMH10-63		▲			100	BT50H100-WE12	▲	
				100	BT40H100-WE10		▲			160	BT50H160-WE12	▲	
				160	BT40H160-WE10		▲			200	BT50H200-WE12	▲	
	10	35	35	200	BT40H200-WE10		▲	14	44	80	BT50AD/B-EMH14-80	▲	
				63	BT40AD/B-EMH12-63		▲			100	BT50H100-WE14	▲	
100				BT40H100-WE12	▲		160			BT50H160-WE14	▲		
160				BT40H160-WE12	▲		200			BT50H200-WE14	▲		
12	42	42	200	BT40H200-WE12	▲		16	44	44	BT50AD/B-EMH16-44	▼		
			63	BT40AD/B-EMH14-63	▲				48	BT50AD/B-EMH16-80	▲		
			100	BT40H100-WE14	▲				48	BT50H100-WE16	▲		
			160	BT40H160-WE14	▲				160	BT50H160-WE16	▲		
14	44	44	200	BT40H200-WE14	▲	18	50	80	BT50AD/B-EMH18-80	▲			
			44	BT40AD/B-EMH16-35	▲			100	BT50H100-WE18	▲			
			48	BT40AD/B-EMH16-63	▲			160	BT50H160-WE18	▲			
			48	BT40H100-WE16	▲			200	BT50H200-WE16	▼			
16	48	48	48	BT40H160-WE16	▲	20	50	44	BT50AD/B-EMH20-44	▼			
			48	BT40H200-WE16	▲			52	80	BT50AD/B-EMH20-80	▲		
			63	BT40AD/B-EMH18-63	▲			52	100	BT50H100-WE20	▲		
			100	BT40H100-WE18	▲			52	160	BT50H160-WE20	▲		
18	50	50	160	BT40H160-WE18	▲	25	50	52	200	BT50H200-WE20	▲		
			200	BT40H200-WE18	▲			32	72	70	44	BT50AD/B-EMH25-44	▲
			44	BT40AD/B-EMH20-35	▲					65	100	BT50AD/B-EMH25-100	▲
			52	BT40AD/B-EMH20-63	▲					65	160	BT50H160-WE25	▲
52	BT40H100-WE20	▲	65	200	BT50H200-WE25	▼							
20	52	52	160	BT40H160-WE20	▲	40	72	80	44	BT50AD/B-EMH32-44	▲		
			200	BT40H200-WE20	▲			72	105	BT50AD/B-EMH32-105	▲		
			44	BT40AD/B-EMH25-35	▲			72	160	BT50H160-WE32	▲		
			65	90	BT40AD/B-EMH25-90			▲	72	200	BT50H200-WE32	▼	
25	65	65	100	BT40-SLA25-100	▲	50	90	90	120	BT50AD/B-EMH40-120	▲		
			160	BT40H160-WE25	▲			80	160	BT50H160-WE40	▲		
			200	BT40H200-WE25	▲			80	200	BT50H200-WE40	▼		
			100	BT40AD/B-EMH32-100	▲			125	BT50AD/B-EMH50-125	▼			
32	72	72	160	BT40H160-WE32	▲								
			200	BT40H200-WE32	▲								
			40	90	120	BT40AD/B-EMH40-120	▲						

▲ UK stock - Generally x-stock for next day delivery ▼ European stock - Generally 2-3 days delivery (please check for lead times)





END MILL HOLDERS DIN 69871

Side Lock Arbors for Weldon & Flat Shank Tools

- ▶ Balanced to G6.3 15,000RPM
- ▶ ≤200mm gauge length



P990



BALANCED 15,000RPM • G6.3

Taper	Dia.	Nose Dia.	Gauge Length	ORDER CODE	PRICE	Taper	Dia.	Nose Dia.	Gauge Length	ORDER CODE	PRICE
SK40	6	25	50	SK40AD/B-EMH6-50	▲	SK50	6	25	63	SK50AD/B-EMH6-63	▲
			100	SK40H100-WE06	▲				100	SK50H100-WE06	▲
			160	SK40H160-WE06	▲				160	SK50H160-WE06	▲
			200	SK40H200-WE06	▼				200	SK50H200-WE06	▼
	8	28	50	SK40AD/B-EMH8-50	▲		8	28	63	SK50AD/B-EMH8-63	▲
			100	SK40H100-WE08	▲				100	SK50H100-WE08	▲
			160	SK40H160-WE08	▲				160	SK50H160-WE08	▲
			200	SK40H200-WE08	▼				200	SK50H200-WE08	▼
	10	35	50	SK40AD/B-EMH10-50	▲		10	35	63	SK50AD/B-EMH10-63	▲
			100	SK40H100-WE10	▲				100	SK50H100-WE10	▲
			160	SK40H160-WE10	▲				160	SK50H160-WE10	▲
			200	SK40H200-WE10	▼				200	SK50H200-WE10	▼
	12	42	50	SK40AD/B-EMH12-50	▲		12	42	63	SK50AD/B-EMH12-63	▲
			100	SK40H100-WE12	▲				100	SK50H100-WE12	▲
			160	SK40H160-WE12	▲				160	SK50H160-WE12	▲
			200	SK40H200-WE12	▼				200	SK50H200-WE12	▼
	14	44	50	SK40AD/B-EMH14-50	▲		14	44	63	SK50AD/B-EMH14-63	▲
			100	SK40H100-WE14	▲				100	SK50H100-WE14	▲
			160	SK40H160-WE14	▲				160	SK50H160-WE14	▲
			200	SK40H200-WE14	▼				200	SK50H200-WE14	▼
	16	48	35	SK40AD/B-EMH16-35	▲		16	48	63	SK50AD/B-EMH16-63	▲
			63	SK40AD/B-EMH16-63	▲				100	SK50H100-WE16	▲
			100	SK40H100-WE16	▲				160	SK50H160-WE16	▲
			160	SK40H160-WE16	▲				200	SK50H200-WE16	▼
			200	SK40H200-WE16	▼				18	50	63
	63	SK40AD/B-EMH18-63	▲	100	SK50H100-WE18		▲				
	100	SK40H100-WE18	▲	160	SK50H160-WE18		▲				
	160	SK40H160-WE18	▲	200	SK50H200-WE18		▼				
20	52	35	SK40AD/B-EMH20-35	▲	20	52	63	SK50AD/B-EMH20-63	▲		
		63	SK40AD/B-EMH20-63	▲			100	SK50H100-WE20	▲		
		100	SK40H100-WE20	▲			160	SK50H160-WE20	▲		
		160	SK40H160-WE20	▲			200	SK50H200-WE20	▼		
		200	SK40H200-WE20	▼			25	65	80	SK50AD/B-EMH25-80	▲
44	SK40AD/B-EMH25-35	▲	160	SK50H160-WE25	▲						
100	SK40AD/B-EMH25-100	▲	200	SK50H200-WE25	▼						
160	SK40H160-WE25	▲	32	72	100	SK50AD/B-EMH32-100			▲		
200	SK40H200-WE25	▼			160	SK50H160-WE32	▲				
70	SK40AD/B-EMH32-100	▲			200	SK50H200-WE32	▼				
160	SK40H160-WE32	▲			40	80	120	SK50AD/B-EMH40-120	▲		
200	SK40H200-WE32	▼	160	SK50H160-WE40			▲				
40	SK40AD/B-EMH40-120	▲	200	SK50H200-WE40			▼				
40	90	120	SK40AD/B-EMH40-120	▲	50	95	125	SK50AD/B-EMH50-125	▼		

▲ UK stock - Generally x-stock for next day delivery ▼ European stock - Generally 2-3 days delivery (please check for lead times)





END MILL HOLDERS HSK-A

Side Lock Arbors for Weldon & Flat Shank Tools

- ▶ Balanced to G6.3 15,000RPM
- ▶ ≤200mm gauge length



BALANCED 15,000RPM • G6.3

Taper	Dia.	Nose Dia.	Gauge Length	ORDER CODE	PRICE	
HSK40A	6	25	60	HSK40-EMH6-60A ▼		
		18	100	HSK40-EMH6-100A ▼		
	8	28	60	HSK40-EMH8-60A ▼		
		22	100	HSK40-EMH8-100A ▼		
	10	35	65	HSK40-EMH10-65A ▲		
		30	100	HSK40-EMH10-100A ▼		
	12	42	70	HSK40-EMH12-70A ▼		
		34	100	HSK40-EMH12-100A ▼		
	16	48	80	HSK40-EMH16-80A ▲		
		20	52	80	HSK40-EMH20-80A ▼	
	HSK50A	6	25		HSK50-EMH6-65A ▼	
		8	28	65	HSK50-EMH8-65A ▼	
10		35		HSK50-EMH10-65A ▼		
12		42		HSK50-EMH12-80A ▼		
14		42		HSK50-EMH14-80A ▼		
16		48	80	HSK50-EMH16-80A ▼		
18		48		HSK50-EMH18-80A ▼		
20		52		HSK50-EMH20-80A ▼		
HSK63A	6	25	65	HSK63-EMH6-65A ▲		
			100	HSK63-EMH6-100A ▲		
			160	HSK63-EMH6-160A ▲		
	8	28	65	HSK63-EMH8-65A ▲		
			100	HSK63-EMH8-100A ▲		
			160	HSK63-EMH8-160A ▲		
	10	35	65	HSK63-EMH10-65A ▲		
			100	HSK63-EMH10-100A ▲		
			160	HSK63-EMH10-160A ▲		
	12	42	80	HSK63-EMH12-80A ▲		
			100	HSK63-EMH12-100A ▲		
			160	HSK63-EMH12-160A ▲		
	14	42	80	HSK63-EMH14-80A ▲		
			100	HSK63-EMH14-100A ▲		
			160	HSK63-EMH14-160A ▼		
	16	48	80	HSK63-EMH16-80A ▲		
			100	HSK63-EMH16-100A ▲		
			160	HSK63-EMH16-160A ▲		
	18	48	80	HSK63-EMH18-80A ▲		
			100	HSK63-EMH18-100A ▲		
			160	HSK63-EMH18-160A ▼		
	20	52	80	HSK63-EMH20-80A ▲		
			100	HSK63-EMH20-100A ▲		
			160	HSK63-EMH20-160A ▲		
25	65	105	HSK63-EMH25-105A ▲			
		160	HSK63-EMH25-160A ▲			
32	72	110	HSK63-EMH32-110A ▲			

Taper	Dia.	Nose Dia.	Gauge Length	ORDER CODE	PRICE
HSK100A	6	25	80	HSK100-EMH6-80A ▲	
			160	HSK100-EMH6-160A ▲	
			200	HSK100-EMH6-200A ▼	
	8	28	80	HSK100-EMH8-80A ▲	
			160	HSK100-EMH8-160A ▲	
			200	HSK100-EMH8-200A ▼	
	10	35	80	HSK100-EMH10-80A ▲	
			160	HSK100-EMH10-160A ▲	
			200	HSK100-EMH10-200A ▼	
	12	42	80	HSK100-EMH12-80A ▲	
			160	HSK100-EMH12-160A ▲	
			200	HSK100-EMH12-200A ▲	
	14	42	80	HSK100-EMH14-80A ▲	
			160	HSK100-EMH14-160A ▼	
			200	HSK100-EMH14-200A ▼	
	16	48	100	HSK100-EMH16-100A ▲	
			160	HSK100-EMH16-160A ▲	
			200	HSK100-EMH16-200A ▲	
	18	48	100	HSK100-EMH18-100A ▼	
			160	HSK100-EMH18-160A ▼	
			200	HSK100-EMH18-200A ▼	
	20	52	100	HSK100-EMH20-100A ▲	
			160	HSK100-EMH20-160A ▲	
			200	HSK100-EMH20-200A ▲	
25	65	100	HSK100-EMH25-100A ▲		
		160	HSK100-EMH25-160A ▲		
		200	HSK100-EMH25-200A ▲		
32	72	100	HSK100-EMH32-100A ▲		
		160	HSK100-EMH32-160A ▲		
		200	HSK100-EMH32-200A ▲		
40	105	105	HSK100-EMH40-105A ▲		
		160	HSK100-EMH40-160A ▲		
		200	HSK100-EMH40-200A ▼		
50	100	160	HSK100-EMH50-160A ▲		
		200	HSK100-EMH50-200A ▼		

COOLANT TUBES & KEYS HSK-A

- ▶ For through coolant supply on HSK tool holders (sold separately)



	HSK50-A	HSK63-A	HSK100-A
COOLANT TUBE	950APR01	963APR01	910APR01
COOLANT TUBE KEY	950CHVAR	963CHVAR	910CHVAR

▲ UK stock - Generally x-stock for next day delivery ▼ European stock - Generally 2-3 days delivery (please check for lead times)





END MILL HOLDERS HSK-E & HSK-F

Side Lock Arbors for Weldon & Flat Shank Tools

HSK-E

► Balanced to G2.5 20,000RPM



HSK-F

► Balanced to G2.5 20,000RPM



BALANCED 20,000RPM • G2.5

Taper	Dia.	Nose Dia.	Gauge Length	ORDER CODE	PRICE
HSK50E	6	25	65	HSK50-EMH6-65E ▼	
	8	28		HSK50-EMH8-65E ▼	
	10	35		HSK50-EMH10-65E ▼	
	12	42	80	HSK50-EMH12-80E ▼	
	14	42		HSK50-EMH14-80E ▼	
	16	48		HSK50-EMH16-80E ▲	
	18	48		HSK50-EMH18-80E ▼	
	20	52		HSK50-EMH20-80E ▼	
	25	65	105	HSK50-EMH25-105E ▼	
HSK63E	6	25	65	HSK63-EMH6-65E ▼	
	8	28		HSK63-EMH8-65E ▼	
	10	35		HSK63-EMH10-65E ▼	
	12	42	80	HSK63-EMH12-80E ▼	
	14	42		HSK63-EMH14-80E ▼	
	16	48		HSK63-EMH16-80E ▼	
	20	52		HSK63-EMH20-80E ▼	
	25	65		105	HSK63-EMH25-105E ▼
	32	72	110	HSK63-EMH32-110E ▼	

BALANCED 20,000RPM • G2.5

Taper	Dia.	Nose Dia.	Gauge Length	ORDER CODE	PRICE
HSK50F	6	25	65	HSK50-EMH6-65F ▼	
	8	28		HSK50-EMH8-65F ▼	
	10	35		HSK50-EMH10-65F ▼	
	12	42	80	HSK50-EMH12-80F ▼	
	14	42		HSK50-EMH14-80F ▼	
	16	48		HSK50-EMH16-80F ▲	
	18	48		HSK50-EMH18-80F ▼	
	20	52		HSK50-EMH20-80F ▼	
	25	65	105	HSK50-EMH25-105F ▼	
HSK63F	6	25	65	HSK63-EMH6-65F ▼	
	8	28		HSK63-EMH8-65F ▼	
	10	35		HSK63-EMH10-65F ▲	
	12	42	80	HSK63-EMH12-80F ▼	
	14	42		HSK63-EMH14-80F ▼	
	16	48		HSK63-EMH16-80F ▼	
	20	52		HSK63-EMH20-80F ▲	

▲ UK stock - Generally x-stock for next day delivery ▼ European stock - Generally 2-3 days delivery (please check for lead times)

COOLANT TUBES & KEYS HSK-E

► For through coolant supply on HSK tool holders (sold separately)



	HSK40-E	HSK50-E	HSK63-E
COOLANT TUBE	950APR02	950APR01	963APR01
COOLANT TUBE KEY	816-204022	950CHVAR	963CHVAR

COOLANT TUBES & KEYS HSK-F

► For through coolant supply on HSK tool holders (sold separately)



	HSK50-F	HSK63-F
COOLANT TUBE	950APR02	950APR01
COOLANT TUBE KEY	816-204022	950CHVAR





END MILL HOLDERS PSC POLYGON SHANK

Side Lock Arbors for Weldon & Flat Shank Tools

► Compatible with Capto

CAPTO
COMPATIBLE



CAPTO COMPATIBLE

Taper	Dia.	Nose Dia.	Gauge Length	ORDER CODE	PRICE
PSC40	6	25	50	C40H50WE06 ▼	
	8	28		C40H50WE08 ▼	
	10	35		C40H50WE10 ▼	
	12	42	55	C40H55WE12 ▼	
	14	44		C40H55WE14 ▼	
	16	48		C40H55WE16 ▼	
PSC50	6	25	55	C50H55WE06 ▼	
	8	28		C50H55WE08 ▼	
	10	35		C50H65WE10 ▼	
	12	42	65	C50H65WE12 ▼	
	14	42		C50H65WE14 ▼	
	16	48		C50H65WE16 ▼	
	18	48		C50H65WE18 ▼	
	20	52		C50H65WE20 ▼	
	25	65		C50H80WE25 ▼	
PSC63	6	25	55	C63H55WE06 ▲	
	8	28		C63H55WE08 ▲	
	10	35		C63H60WE10 ▲	
	12	42	60	C63H60WE12 ▲	
	14	44		C63H60WE14 ▲	
	16	48	65	C63H65WE16 ▲	
	20	52		C63H65WE20 ▲	
	25	64		C63H80WE25 ▲	
	32	72	90	C63H90WE32 ▲	
	40	92	80	18.306.063.40 ▲	

Taper	Dia.	Nose Dia.	Gauge Length	ORDER CODE	PRICE
PSC80	6	25	70	C80H70WE06 ▼	
	8	28		C80H70WE08 ▼	
	10	35		C80H70WE10 ▼	
	12	42		C80H70WE12 ▼	
	14	44		C80H70WE14 ▼	
	16	48		C80H70WE16 ▼	
	20	50	C80H70WE20 ▼		
	25	52	80	C80H80WE25 ▼	
	32	72		C80H80WE32 ▼	
40	80	110		C80H110WE40 ▼	
PSC100	12	42	100	18.306.100.12 ▼	
	16	48		18.306.100.16 ▼	
	20	52		18.306.100.20 ▼	
	25	65		18.306.100.25 ▼	
	32	72		18.306.100.32 ▼	
	40	80		120	18.306.100.40 ▼
	50	100	130	18.306.100.50 ▼	

DOUBLE ASSEMBLY POT PSC

► For vertical and horizontal assembly

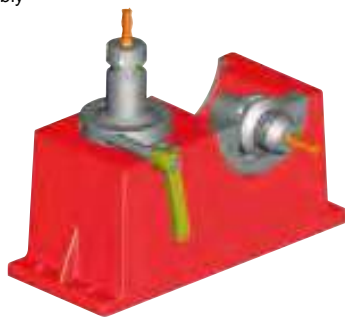

Taper	Capto Ref.	ORDER CODE	PRICE
PSC30	C3	237-33110 ▼	
PSC40	C4	237-33210 ▼	
PSC50	C5	237-33310 ▲	
PSC63	C6	237-33410 ▲	
PSC80	C8	237-33510 ▲	
PSC100	C10	237-33610 ▼	

FULL RANGE OF PSC TAPER HOLDERS AT CUTWEL.CO.UK

- Milling, drilling & tapping holders
- Turning holders
- Adapters & extensions



Turning Tools & Boring Bars



Test Bars



Blanks



Boring Bar Holders



Turning Tool Holders



▲ UK stock - Generally x-stock for next day delivery ▼ European stock - Generally 2-3 days delivery (please check for lead times)





END MILL HOLDERS DOUBLE CONTACT, DBT & DSK

Side Lock Arbors for Weldon & Flat Shank Tools

DBT

- ▶ Balanced to G6.3 15,000RPM
- ▶ For BT MAS Double Contact spindles

DOUBLE CONTACT



P990



DSK

- ▶ Balanced to G2.5 15,000RPM
- ▶ For DIN 69871 Double Contact spindles

DOUBLE CONTACT



P990



BALANCED 15,000RPM • G6.3

Taper	Dia.	Nose Dia,	Gauge Length	ORDER CODE	PRICE	
DBT30	6	25	60	DBT30-EMH6-60 ▼		
	8	28		DBT30-EMH8-60 ▼		
	10	35		DBT30-EMH10-60 ▼		
	12	42		DBT30-EMH12-60 ▼		
	16	48		DBT30-EMH16-75 ▼		
	20	52		DBT30-EMH20-75 ▼		
DBT40	25	65	90	DBT30-EMH25-90 ▼		
	6	25	63	DBT40-EMH6-50 ▼		
	8	28		DBT40-EMH8-50 ▼		
	10	35		DBT40-EMH10-63 ▼		
	12	42		DBT40-EMH12-63 ▼		
	16	48		DBT40-EMH16-63 ▼		
	18	50		DBT40-EMH18-63 ▼		
20	52	DBT40-EMH20-63 ▼				
DBT50	25	65	100	DBT40-EMH25-100 ▼		
	32	72		DBT40-EMH32-100 ▼		
	6	25		63	DBT50-EMH6-50 ▼	
	8	28			DBT50-EMH8-50 ▼	
	10	35			DBT50-EMH10-63 ▼	
	12	42			DBT50-EMH12-63 ▼	
	16	48			DBT50-EMH16-63 ▼	
	18	50			DBT50-EMH18-63 ▼	
20	52	DBT50-EMH20-63 ▼				
25	65	DBT50-EMH25-100 ▼				
DBT50	32	72	100	DBT50-EMH32-100 ▼		
	40	80		DBT50-EMH40-120 ▼		

BALANCED 15,000RPM • G6.3

Taper	Dia.	Nose Dia,	Gauge Length	ORDER CODE	PRICE	
DSK40	6	25	50	DSK40-EMH6-50 ▼		
	8	28		DSK40-EMH8-50 ▼		
	10	35		DSK40-EMH10-50 ▼		
	12	42		DSK40-EMH12-50 ▼		
	16	48		DSK40-EMH16-63 ▼		
	18	50		DSK40-EMH18-63 ▼		
	20	52		DSK40-EMH20-63 ▼		
	25	65		100	DSK40-EMH25-100 ▼	
	32	72		100	DSK40-EMH32-100 ▼	
DSK50	6	25	63	DSK50-EMH6-63 ▼		
	8	28		DSK50-EMH8-63 ▼		
	10	35		DSK50-EMH10-63 ▼		
	12	42		DSK50-EMH12-63 ▼		
	16	48		DSK50-EMH16-63 ▼		
	18	50		DSK50-EMH18-63 ▼		
	20	52		DSK50-EMH20-63 ▼		
	25	65		80	DSK50-EMH25-80 ▼	
	32	72		100	DSK50-EMH32-100 ▼	
	40	80		120	DSK50-EMH40-120 ▼	

END MILL HOLDERS CBT

- ▶ Balanced to G6.3 15,000RPM
- ▶ Compatible with BIG PLUS spindles

DOUBLE CONTACT



P990



BALANCED 15,000RPM • G6.3

Taper	Dia.	Nose Dia,	Gauge Length	ORDER CODE	PRICE
CBT40	6	25	60	CBT40-SLA6-60 ▲	
	8	28		CBT40-SLA8-60 ▲	
	10	35		CBT40-SLA10-60 ▲	
	12	42		CBT40-SLA12-60 ▲	
	16	48	90	CBT40-SLA16-90 ▲	
	20	52		CBT40-SLA20-90 ▲	
	25	65		CBT40-SLA25-90 ▲	
	32	72		CBT40-SLA32-90 ▲	
	40	80		CBT40-SLA40-90 ▲	

▲ UK stock - Generally x-stock for next day delivery ▼ European stock - Generally 2-3 days delivery (please check for lead times)





END MILL HOLDERS DIN 2080 & QUICK CHANGE

Side Lock Arbors for Weldon & Flat Shank Tools

DIN 2080

► For metric draw bars



QUICK CHANGE

► Compatible with Erickson Quick Change system



BALANCED 15,000RPM • G6.3 FOR METRIC DRAW BARS

Taper	Dia.	Nose Dia.	Gauge Length	ORDER CODE	PRICE
ISO30	6	25	40	ISO30-EM6-40 ▲	
	8	28		ISO30-EM8-40 ▲	
	10	35		ISO30-EM10-40 ▲	
	12	42		ISO30-EM12-40 ▲	
	16	48	50	ISO30-EM16-50 ▲	
	20	52	63	ISO30-EM20-63 ▲	
	25	65	68	ISO30-EM25-68 ▲	
ISO40	6	25	50	ISO40-EM6-50 ▲	
	8	28		ISO40-EM8-50 ▲	
	10	35		ISO40-EM10-50 ▲	
	12	42		ISO40-EM12-50 ▲	
	16	48	63	ISO40-EM16-63 ▲	
	20	52	63	ISO40-EM20-63 ▲	
	25	65	80	ISO40-EM25-80 ▲	
	32	72	90	ISO40-EM32-90 ▲	
ISO50	6	25	63	ISO50-EM6-63 ▼	
	8	28		ISO50-EM8-63 ▼	
	10	35		ISO50-EM10-63 ▼	
	12	42		ISO50-EM12-63 ▲	
	16	48	63	ISO50-EM16-63 ▲	
	20	52	63	ISO50-EM20-63 ▲	
	25	65	80	ISO50-EM25-80 ▲	
	32	72	80	ISO50-EM32-80 ▲	
	40	90	90	ISO50-EM40-90 ▲	

BALANCED 15,000RPM • G6.3 FOR METRIC DRAW BARS

Taper	Dia.	Nose Dia.	Gauge Length	ORDER CODE	PRICE
QC30	6	25	50	ISO30-EM6-50QC ▲	
	8	28		ISO30-EM8-50QC ▲	
	10	35		ISO30-EM10-50QC ▲	
	12	42	50	ISO30-EM12-50QC ▲	
	16	48	63	ISO30-EM16-63QC ▲	
	20	52	63	ISO30-EM20-63QC ▲	
QC40	6	25	50	ISO40-EM6-50QC ▲	
	8	28		ISO40-EM8-50QC ▲	
	10	35		ISO40-EM10-50QC ▲	
	12	42		ISO40-EM12-50QC ▲	
	16	48	63	ISO40-EM16-63QC ▲	
	20	52	63	ISO40-EM20-63QC ▲	
	25	65	85	ISO40-EM25-85QC ▲	
	32	72	90	ISO40-EM32-90QC ▲	

DOUBLE ASSEMBLY POT DIN 2080

► For vertical and horizontal assembly



Taper	ORDER CODE	PRICE
ISO30 DIN2080	237-32110 ▲	£223.86
ISO40 DIN2080	237-32310 ▲	£223.86
ISO50 DIN2080	237-32510 ▼	£223.86

▲ UK stock - Generally x-stock for next day delivery ▼ European stock - Generally 2-3 days delivery (please check for lead times)





END MILL HOLDERS R8 & WELDON

Side Lock Arbors for Weldon & Flat Shank Tools

END MILL HOLDERS R8

► R8 Bridgeport Taper



R8

EXTENSIONS/REDUCTION SLEEVES WELDON

► Ideal for extended tool holder reach
► Also for reducing clamping diameter



WE

R8 FOR BRIDGEPORT CONVENTIONAL MILLING MACHINES

Taper	Dia.	Nose Dia.	Gauge Length	ORDER CODE	PRICE
R8	6	25	55	R8-SLA6-55 ▲	
	8	28		R8-SLA8-55 ▲	
	10	35		R8-SLA10-55 ▲	
	12	42		R8-SLA12-55 ▲	
	16	48	60	R8-SLA16-60 ▲	
	20	52	65	R8-SLA20-65 ▲	
	25	65	65	R8-SLA25-65 ▲	
	32	72	100	R8-SLA32-100 ▲	

R8 FOR BRIDGEPORT CONVENTIONAL MILLING MACHINES

Shank Dia.	Dia.	Shank Length	Head Length	ORDER CODE	PRICE
20	6	50	30	WE20H30WE06 ▼	
	8		30	WE20H30WE08 ▼	
	10		30	WE20H30WE10 ▼	
	12	50	35	WE20H35WE12 ▼	
	16		60	WE20H60WE16 ▼	
25	6	56	25	WE25H25WE06 ▼	
	8		30	WE25H30WE08 ▼	
	10		30	WE25H30WE10 ▼	
	12		35	WE25H35WE12 ▼	
	16		40	WE25H40WE16 ▼	
32	8	60	30	WE32H30WE08 ▼	
	10		30	WE32H30WE10 ▼	
	12	60	35	WE32H35WE12 ▼	
	16	60	40	WE32H40WE16 ▼	
	20		40	WE32H40WE20 ▼	
25	60	65	WE32H65WE25 ▼		

▲ UK stock - Generally x-stock for next day delivery ▼ European stock - Generally 2-3 days delivery (please check for lead times)

www.cutwel.co.uk is one of the fastest & easiest ways to purchase any of our products. With up to date stock levels & prices it is an excellent platform to progress any orders you have or to put together a quotation before ordering.



ON ORDERS OVER £75 PLACED BEFORE 6PM

call **01924 869610** or visit www.cutwel.co.uk today



*Exclusions apply.

