



Engineering Maintenance,
Manufacturing & Laboratory
APPRENTICESHIPS



M53 Northbound

Leave M53 at Junction 10. Take 3rd Exit at roundabout next to Lexus Garage onto Stanney Mill Road. Follow Stanney Mill Road over canal bridge into New Bridge Road. TTE is on the right after 1/2 mile.

M53 Southbound

Leave M53 at Junction 9. At roundabout take 1st Exit onto Oil Sites Road with the Boat Museum on the left. Carry on past Greif to Innospec. Turn right onto Bridges Road and continue into New Bridge Road. TTE is on the left after 1/2 mile.

By Rail

Ellesmere Port Station is a short taxi ride from TTE.

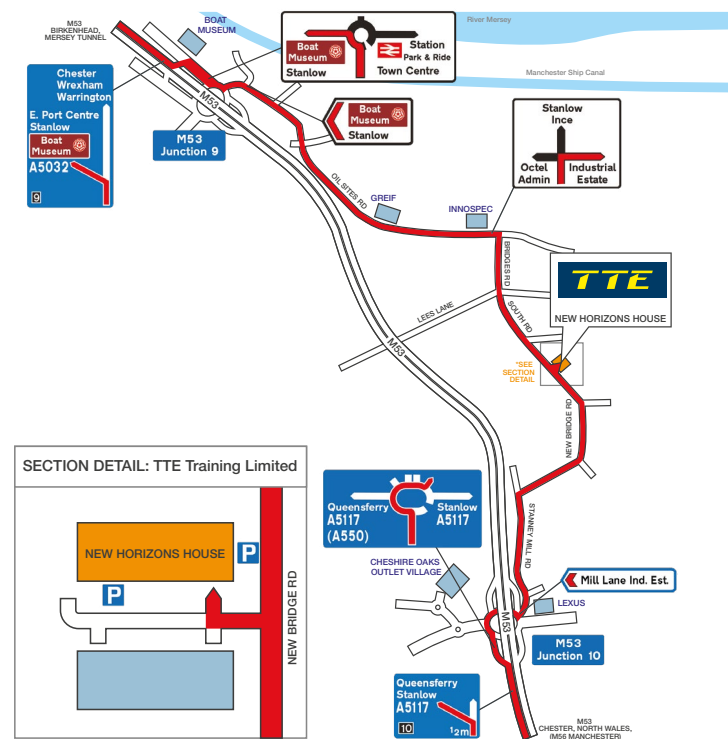

TTE Training Limited

New Horizons House, New Bridge Road, Ellesmere Port CH65 4LT

For further information contact TTE on:
0151 357 6100
information@tetraining.ltd.uk
tteltd.co.uk



Engineering Maintenance,
Manufacturing & Laboratory
APPRENTICESHIPS

What are you waiting for?...



Why Choose TTE?

TTE Training Limited is a training provider set up by industry for industry. TTE was established in Ellesmere Port, Cheshire in 1990 by Inovyn (formerly Ineos ChlorVinyls), Innospec (formerly Associated Octel) and Essar Oil UK (formerly Shell UK) to provide training not only for their own companies but other multi-national companies in the chemical, petrochemical, process, power, paper, pharmaceutical, nuclear and oil and gas industries throughout the North West.

TTE has grown to become one of the North West's leading providers of Level 3 apprenticeships in engineering, manufacturing and laboratory operations with whole person development incorporated into the training.

In 2001, TTE invested £1.8 million in a purpose-built training centre to provide the manufacturing industry with the finest young people trained to the highest standards.



How Do We Compare?

TTE aims to be the leading provider of apprenticeships and technical training for the energy, engineering and manufacturing sectors in the North West and boasts an impressive inspection record.

- **Ofsted Outstanding Provider**
- **Nineteen consecutive BSC International Safety Awards**
- **BSC Sector Award winner for Training and Education, Health, Housing, Local Government and Public Services in 2014**



- **BSC '5-Star' graded health and safety management system for the past eighteen years.**
- **9 consecutive RoSPA gold medals, nine times RoSPA Sector Award winner for Training and Education Services and four times 'Highly Commended' in Sector**

Apprenticeship Programmes (Level 3)

What Can TTE Offer?

The TTE Engineering Maintenance or Manufacturing Apprenticeship is a three and a half year work based training programme where you gain practical experience both at TTE's training centre and on site with your employer. This also includes (for the first two years) one day per week (plus an evening) at TTE working towards a BTEC Diploma (or other appropriate qualification)

The programmes include up to two years of broad based or core training at TTE's Training Centre with the remainder delivered on site with your employer. You will specialise in one of the following disciplines:

- **Process/Manufacturing Engineering**
- **Mechanical and Fabrication Engineering**
- **Electrical Engineering**
- **Instrumentation Engineering**

You will complete the following nationally recognised Apprenticeship Standards and Qualifications:

- **Level 3 Science Industry Maintenance Technician OR Level 3 Science Manufacturing Technician**
- **Level 3 BTEC Diploma in Operations and Maintenance Engineering (or other appropriate qualification)**

TTE also offer a two and a half year employer led apprenticeship in Laboratory Operations, based four days per week with your employer and one day per week for the first two years at a local college.

You will complete the following nationally recognised Apprenticeship Standard and Qualification:

- **Level 3 Laboratory Technician Standard**
- **Level 3 BTEC Diploma in Applied Science OR**
- **BTEC Higher National Certificate in Applied Chemistry**



How to Apply

Entry Requirements

- *Minimum of 5 GCSE's Grade 4-9 (or C and above) to include Maths, English Language & a Science (or equivalent)*
- *Have an interest in Engineering and have an interest in practical activities*



Recruitment Process

- Online applications accepted **from November**
- Tests and 1st stage interviews conducted **January - March**
- Closing date **28th February**
- 2nd stage interviews (if selected by an employer) conducted **April and May**
- If selected, training starts September (depending on GCSE results and medical)
- If not selected by an employer there may be other programmes available

**If unsuccessful at any stage there may be other programmes available*

